



# COMPANY PROFILE



Nilüfer Organize Sanayi Bölgesi  
N.118 Sokak. No:10  
Nilüfer/BURSA/TÜRKİYE



Phone: +90(224)411 15 50  
Fax : +90(224)411 15 54



E-Mail: [etka@etkaotomotiv.com](mailto:etka@etkaotomotiv.com)



[www.etkaotomotiv.com](http://www.etkaotomotiv.com)



IATF 16949



IATF 16949



AS 9100



AS 9100



**etka-d**  
mould & plastic  
"together to the future"





# Contents

- 1/2 Contents
- 3/4 About Us
- 5/6 Overview
- 7/8 Product Development
- 9/10 Designing
- 11/12 Prototyping
- 13/14 Prototype Moulding
- 15/16 Silicone Moulding
- 17/18 Reverse Engineering

- 19/20 Mould Design
- 21/22 Mould Equipments
- 23/24 Mould Factory
- 25/26 Plastic Injection Factory
- 27/28 Assembly Line
- 29/30 Knitting Department
- 31/32 Product Range
- 33 Certificates
- 34 Global Service

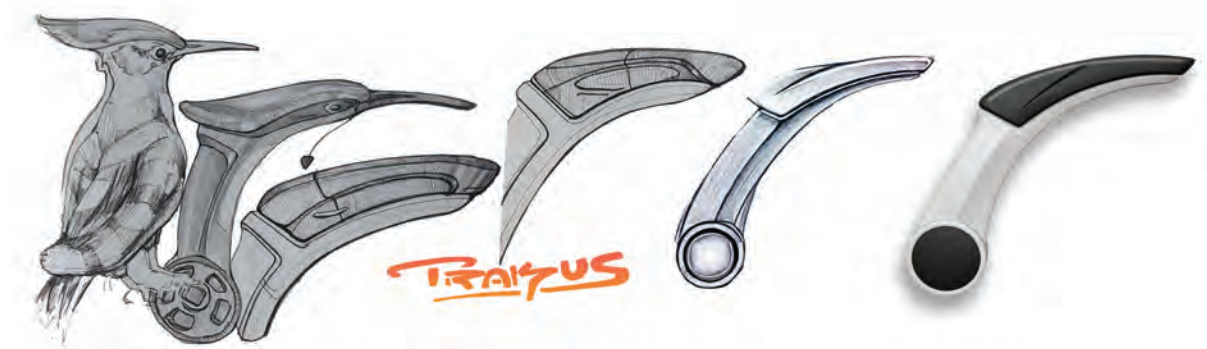

## “nature + quality”

Perfection of nature always inspire us.  
 In Etk-a-d, customer satisfaction is guaranted with innovative vision,  
 high technology, advanced foresight and delivery on time.

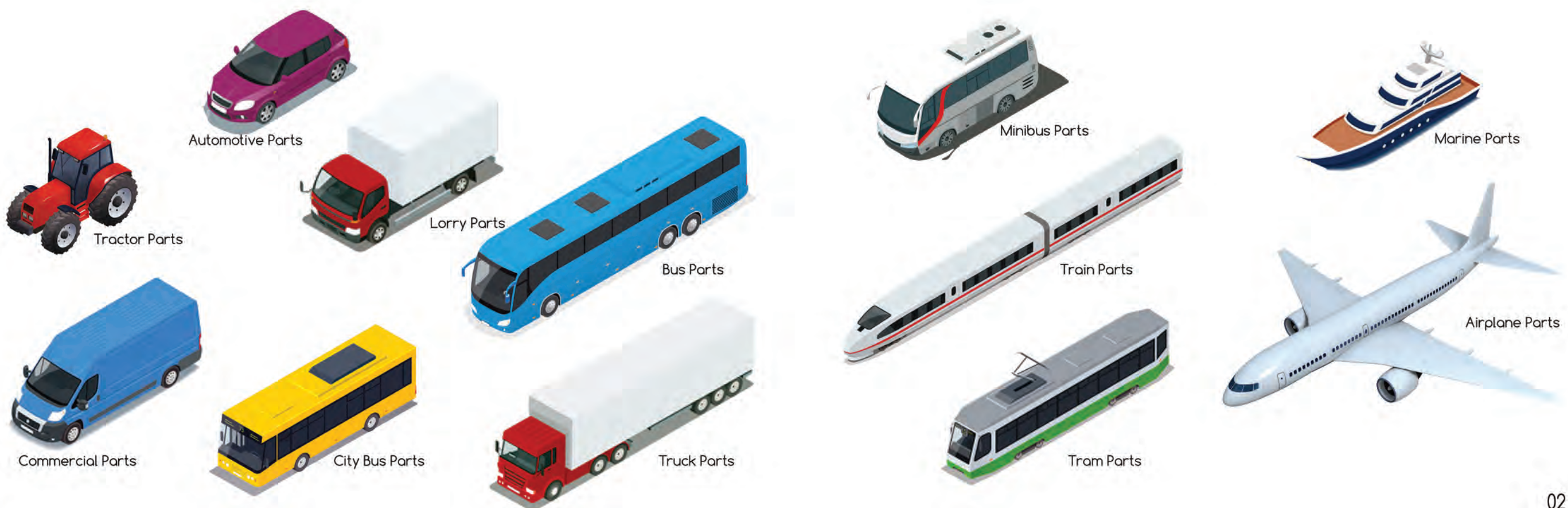





# “We are here for you more than 30 years!”

for product and concept development from the beginning

taking customer satisfaction and fast production as principle

Etk-a-d has been creating engineering solutions since 1990. We are a full-service supplier providing our customers with all kinds of plastic products of any quantity. Thanks to our:

- Design Office and R&D Department
- Prototype Workshop
- Mold Manufacturing
- Plastic Injection Production
- Assembly Lines

We continue to serve our customers with following principle “ The way of achieving success is to meet expectations, the way to become a leader is to guide.”

Our most important asset is the trust of our customers. Therefore, we keep investing in innovation and high technologies to satisfy their needs and complete their requests.

## OUR VISION

The vision of Etk-a-d, from the beginning and which continues to today, is to build the highest quality standarts and development of long term partnership that add real values to our customers. Innovation drives our policy of continuous improvment in manufacturing and customer by pursue of technology, giving importance to human values of employees, customers and community with participatory, sharing and transparent management structure.

## OUR MISSION

Etk-a-d’s mission is to develop performing of plastic and plastic based original designs and production, revealing expectations and demands of all customers with the most economic way from supply chain to the end-user .

We achive customer satisfaction by

- Using Key Technology,
- Fast Mould Production,
- Cooperation,
- High Level of Quality,
- Experience and Understanding.

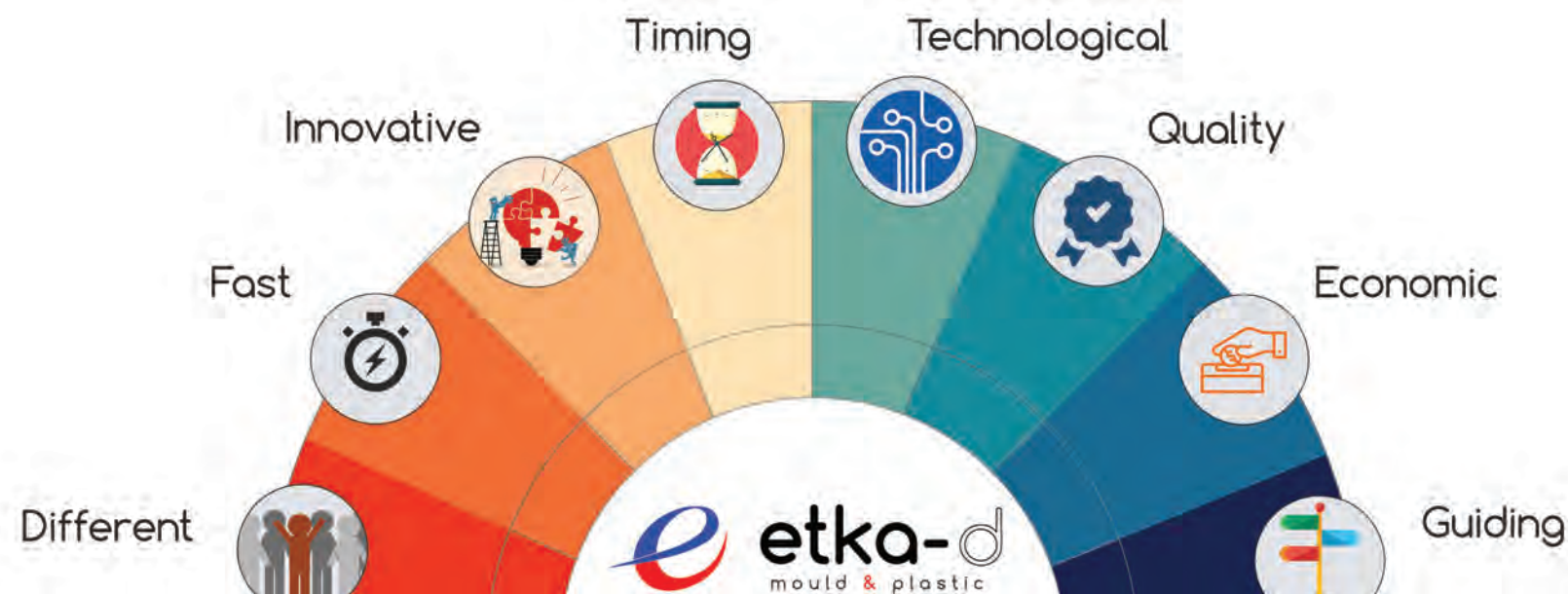



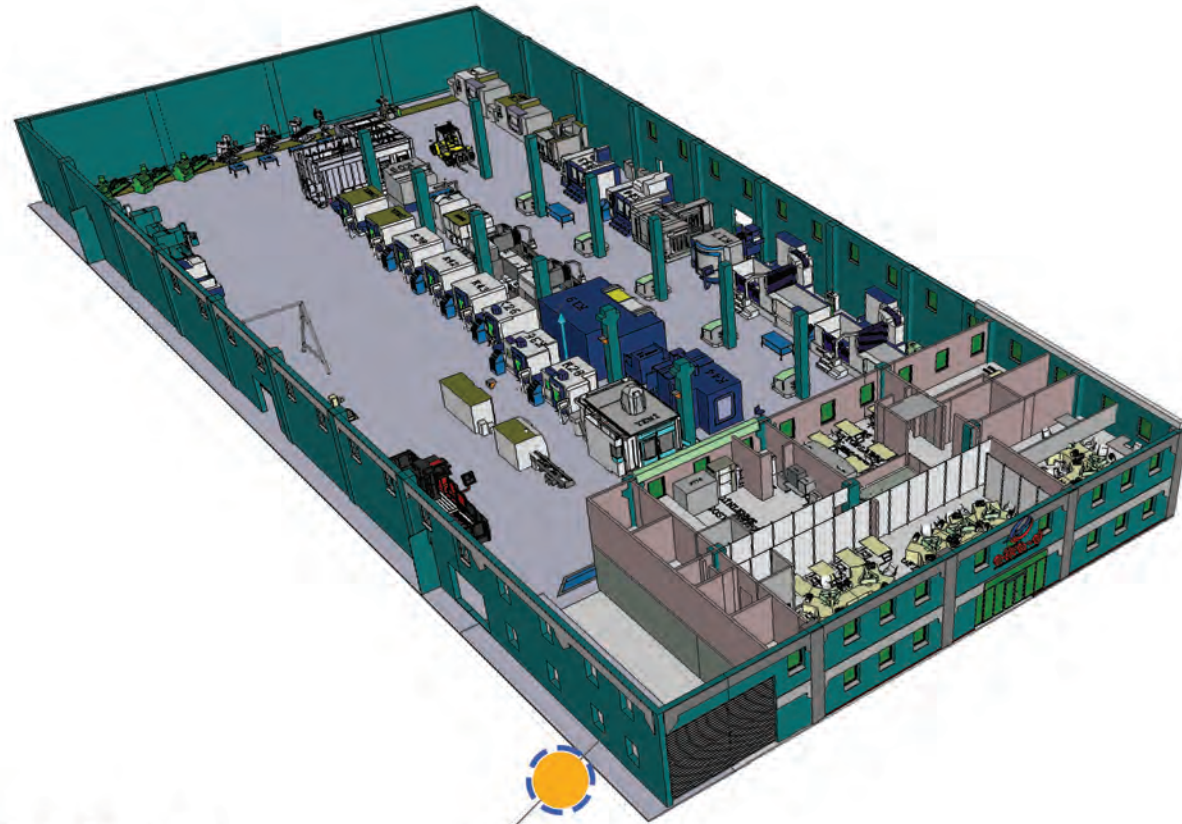

### Mold Factory

- 4000 m2 area
- 40 CNC machines
- Up to 2000 mm 5 axis machining capability

### Plastic Injection Factory

- 5000 m2 area
- 55 plastic injection machines
- 60-3000 tons clamping force
- Up to 25 kg plastic part production

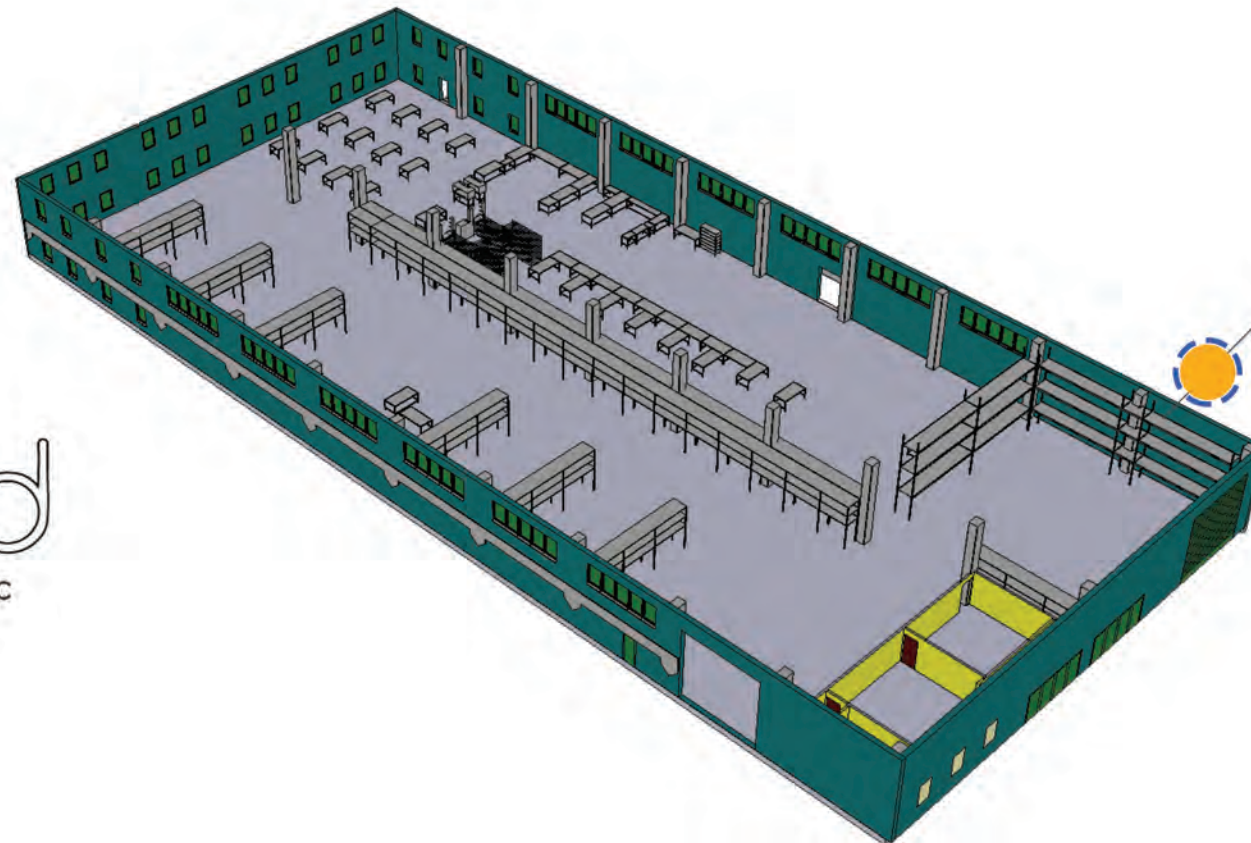
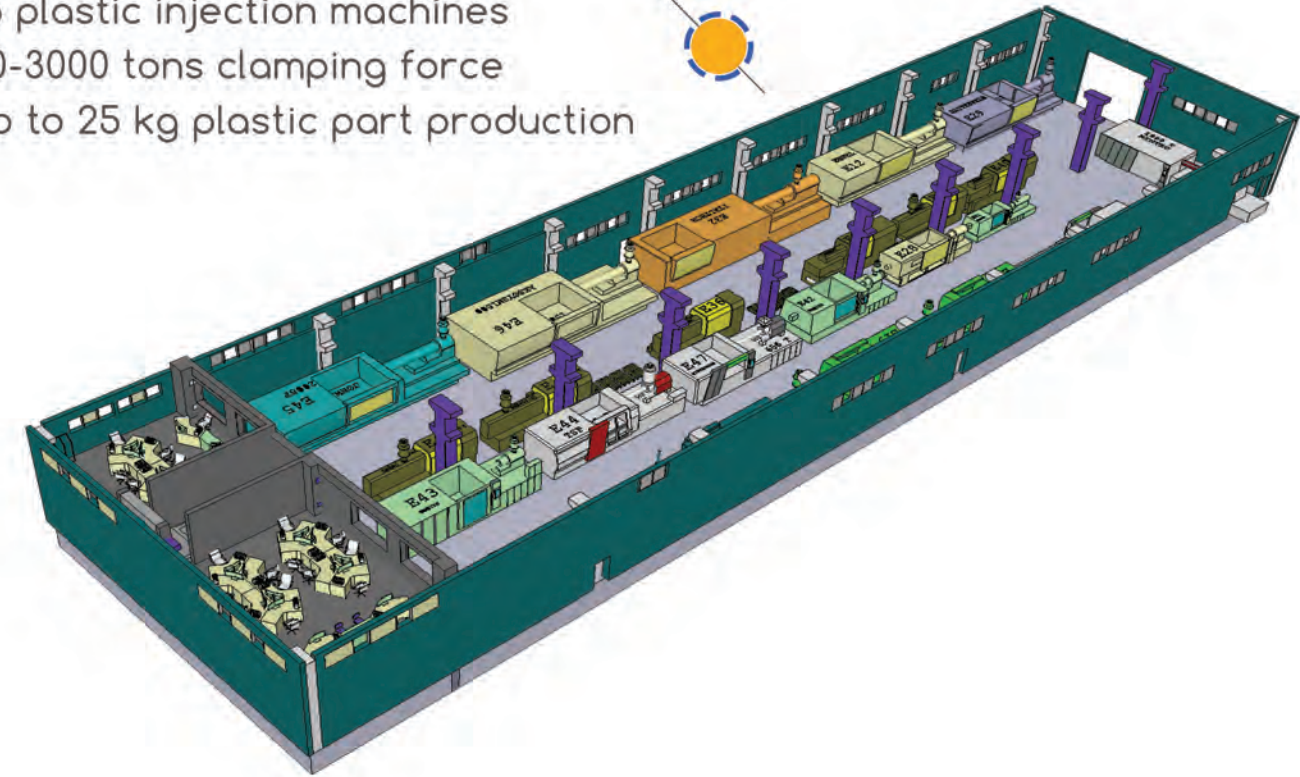

### Assembly Lines & Warehouse

- 3500 m2 area
- 4 knitting machines
- Plastic injections machines
- Ultrasonic weldings







## ...Creating ideas

We always generate ideas and develop them to final products. We are able to support our customers in every stage of product development process.

Therefore, most of our customers contact us on very early stages of their projects and we are able to complete product development together as co-designer.

Idea

Concept Modelling

Industrialization

Prototyping

Analysis

Mould Design

Production

Dimensional Control

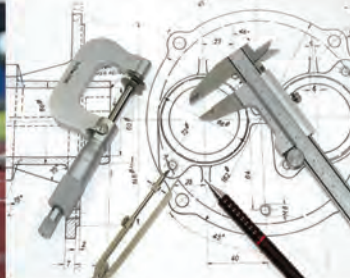





# Designing

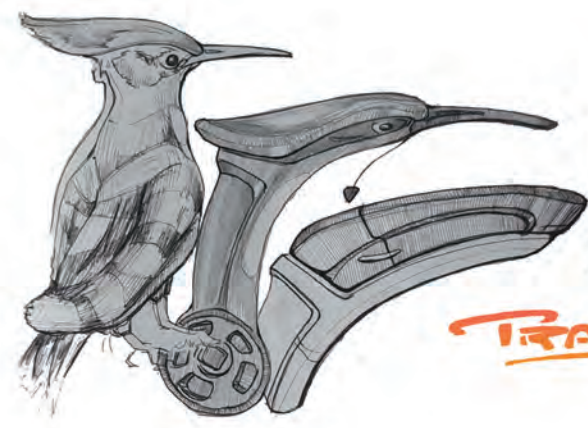
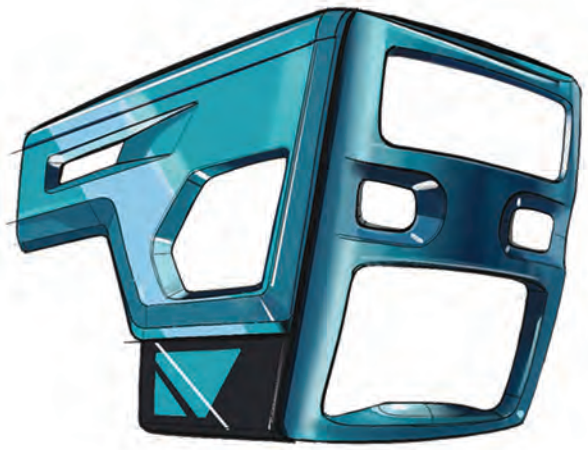
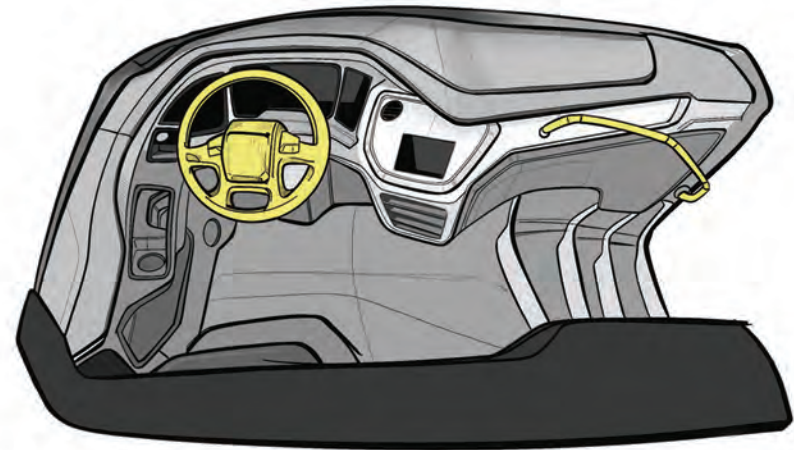

**TRAIKUS**



To design a product that meets customer needs, it's important to conduct research and gather feedback to understand their preferences and requirements. This information can be collected through market research, customer feedback, user testing, and continuous iteration. By following this process, we can create designs that are tailored to meet the needs and expectations of your target audience, resulting in higher customer satisfaction.

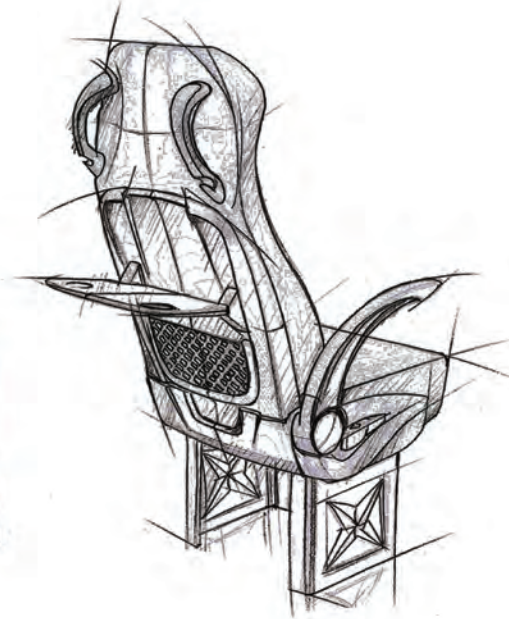





# Prototyping

## We are using prototype technology since 2005



For large scales, Stratasys F770 - up to 1m production size in one shot

During product development phase, producing and testing a prototype is very important stage.

We can quickly turn our designs into physical models with our high prototyping capability. This helps us to check the shape and dimensions of our designs in real life conditions.



For economical production, Stratasys F370



For high resolution, Photocentric LC Magna

Prototypes are not only for geometrical controls, we are able to produce the prototypes under conditions very close to serial production thanks to our expertise and knowledge of the materials and production methods of prototyping.



For high tech material range, Stratasys Fortus MC400



For practical solution, Makerbot MethodX

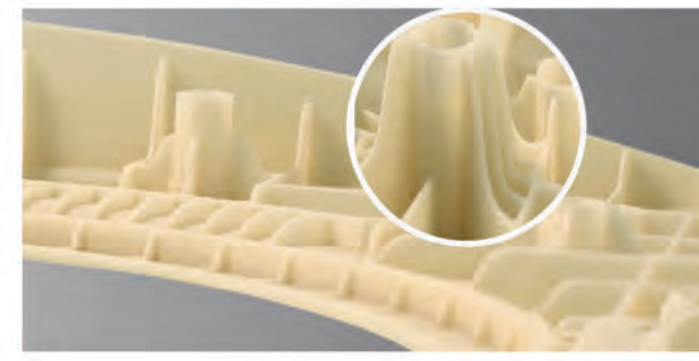





# Prototype Moulding

Before launching serial production, pre-serial production can be needed for low quantities. According to the budget, time plan and requirements of the pre-serial parts, we are offering prototype moulding.

If the customers require parts as same as serial condition in terms of material, colour and texture, the faster and economical way is prototype moulding.

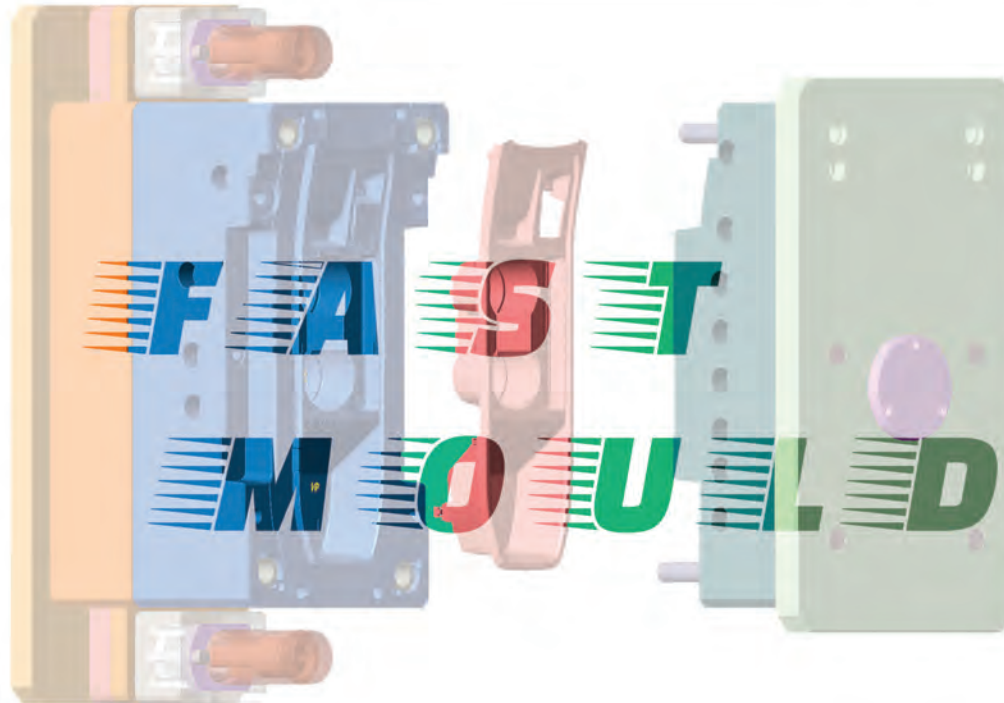

By this method, depending on geometry up to 1000 pcs we are able to get parts faster and more economical than the serial mould and parts will have same features with the end product.

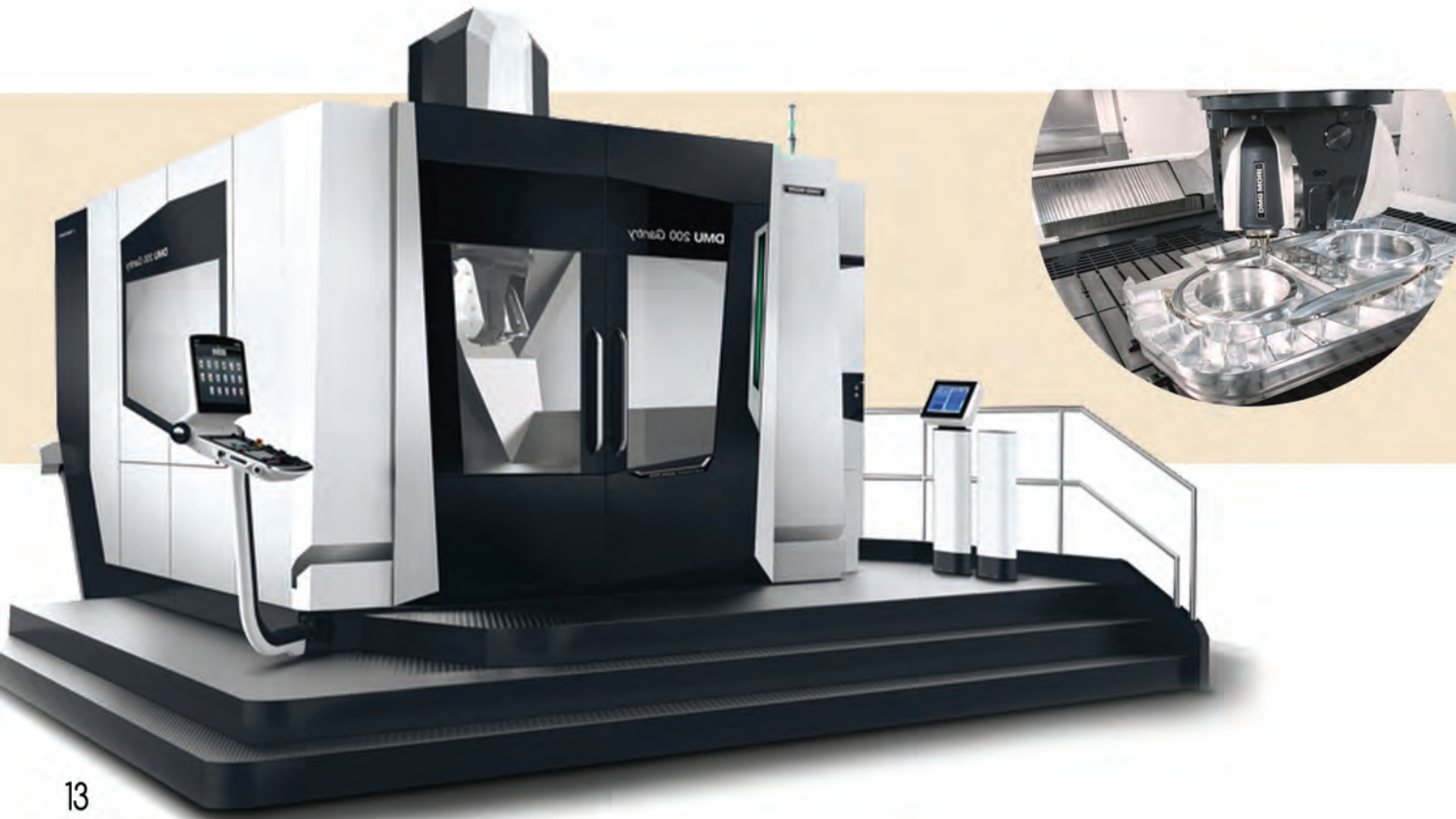

If there is a requirement to test a product under serial condition before design freeze, the solution is again prototype moulding.







# Silicon Moulding

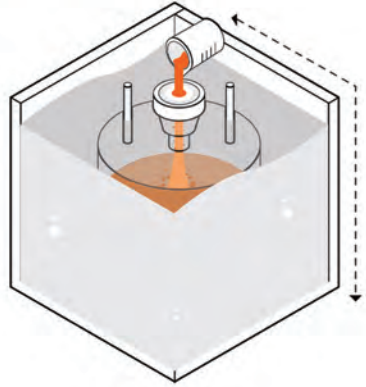

Before launching serial production, pre-serial production can be needed for low quantities.  
According to the budget, time plan and requirements of the pre-serial parts,  
we are also offering silicon moulding .

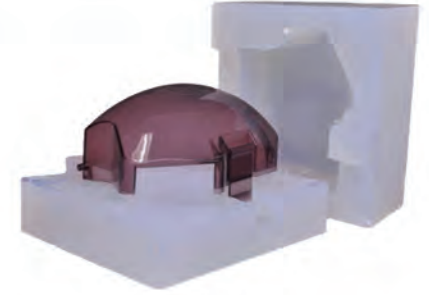

WE ARE THE ONE OF THE FIRST IMPLEMENTER OF  
SILICON MOULDING AND VACUUM CASTING  
IN TÜRKIYE

By this method, low quantities up to 20 to 50 can be produced  
more economically than the prototype production methods. For  
validation of design, if more parts which have very close features  
to serial part is required, silicon moulding can be a fast and  
economic solution.

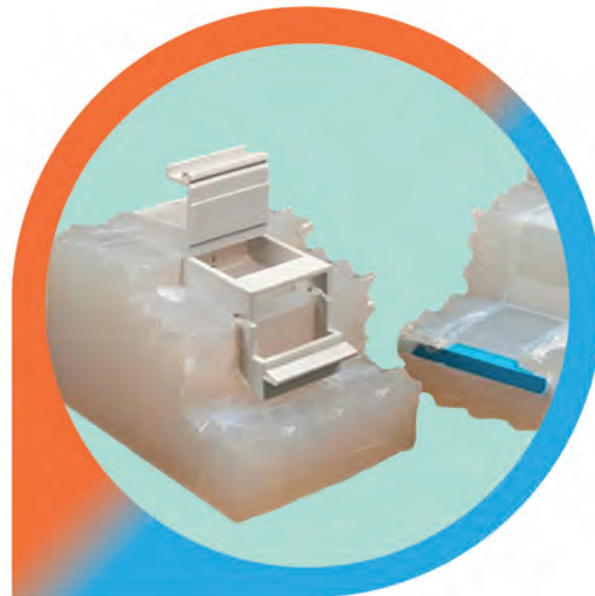





Romer Absolute Arm



Scanning

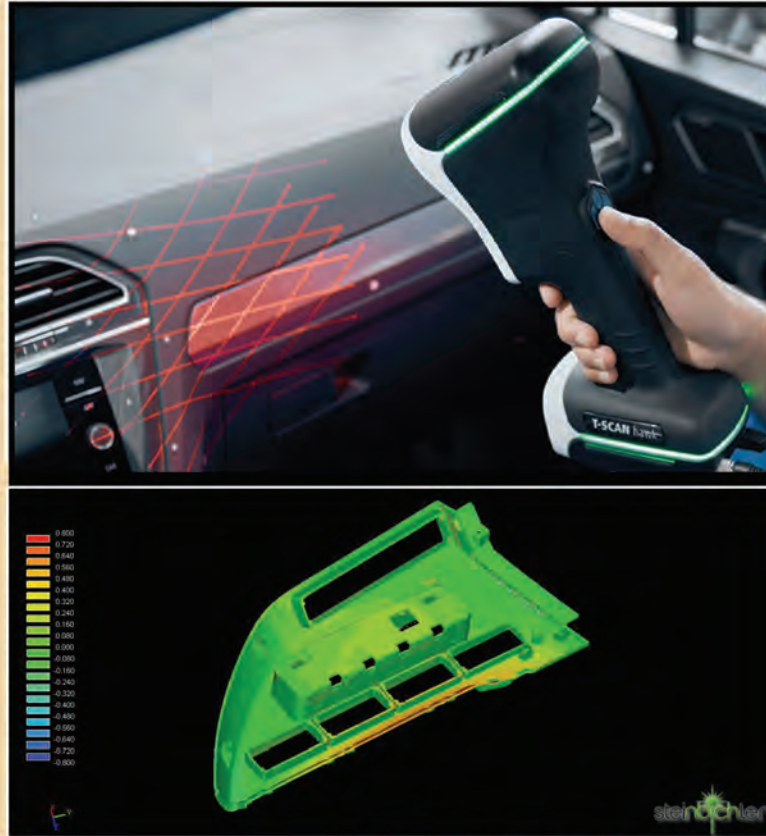

Dimensional Control

After producing parts with any kind of methods, we are able to do dimensional controls by using proper scanning methods according to the requirements;

- Optical scanning
- Portable CMM Arm with integrated scanner
- Handheld 3d Scanner



Zeiss T-Scan Hawk

## High Sensitivity Scanning



Beside dimensional check of the parts, we are able to produce 3d models by scanning reference samples by using all these equipments.



Breuckmann - optoTOP-HE



Steinbichler Comet Led 5M







# Moulding Equipments

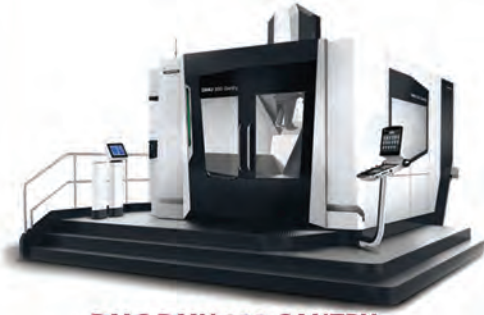

**DMG DMU 200 GANTRY**  
5 Axis VMC  
2250 X 2000  
10 tons loading capacity



**DMG DMF 260/11**  
5 Axis VMC  
3200 X 1100  
4 tons loading capacity

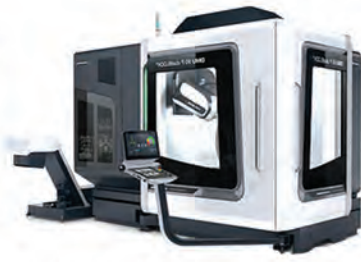

**DMG DMU 90 P duoBLOCK**  
5 Axis VMC  
900 X 1100  
1.8 tons loading capacity



**HERMLE C650**  
5 Axis VMC  
1250 X 980  
3 tons loading capacity



**DMG DMU 75 monoBLOCK**  
5 Axis VMC  
840 X 500  
600 kg loading capacity



**DMG MORI CMX 70U**  
5 Axis VMC  
800 X 560  
350 kg loading capacity  
5 pieces



**DMG MORI CMX 1100V**  
3+2 Axis  
1400 X 560  
1 tons loading capacity



**DMG M1**  
3 Axis VMC  
550x550  
600 kg loading capacity



**DMG SPRINT 32/8**  
8 Axis  
Horizontal Production Turning



**DMG CMX800V**  
3 Axis  
1100x560  
800 kg loading capacity



**DMG CLX 550**  
4 Axis  
700 x 1240



**Hartford HSA 316**  
3 Axis VMC  
3000 X 1400  
10 tons loading capacity



**NDC 3016B**  
3+2 Axis VMC  
3000 x 1500  
10 tons loading capacity



**YCM DCV 3016B**  
3 Axis VMC  
3260 x 1500  
10 tons loading capacity



**YCM DCV 2012B**  
3Axis VMC  
2000x1100  
5 tons loading capacity  
2 pieces

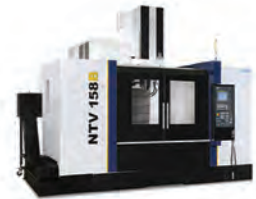

**YCM NTV158B**  
3 Axis  
1650 X 760  
2 tons loading capacity

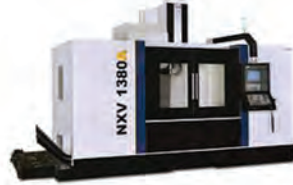

**YCM NXV1380A**  
3 Axis VMC  
1430 X 760  
1.5 tons loading capacity



**YCM NDV/102A**  
3 Axis VMC  
1120 X 650  
1 tons loading capacity



**AWEA BM-1020**  
3 Axis VMC  
1120 X 600  
1 tons loading capacity

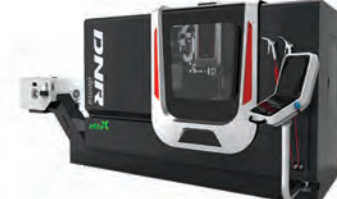

**DNR DEMA EMV-L1600**  
3 Axis  
1750 x700  
1.2 tons loading capacity  
2 pieces



**NCS6Z-1600**  
6 Axis  
3000 mm Deep Hole Drilling  
20 tons loading capacity



**JOINT TL-1600**  
5 Axis  
3200 mm Deep Hole Drilling  
15 tons loading capacity



**YCM EXCETEK W650G**  
4 Axis Wire EDM  
650 X 400  
800 kg loading capacity



**HCM HC1060**  
5 Axis EDM  
1250 x 750  
4.5 tons loading capacity



**HCM HC1060 +300 HIGH**  
5 Axis EDM  
1250 x 750  
4.5 tons loading capacity



**HCM H5040 ZNC**  
3 Axis EDM  
800 X 450  
1.4 tons loading capacity



**JOEMARS P50**  
4 Axis EDM  
600 X 300  
500 kg loading capacity



**AJAN EDM 982**  
3 Axis EDM  
510 X 315  
300 kg loading capacity



**FIRST LC-20VHS**



**JETCO JBE-4**  
2 pieces



**WDM GAD 3050x16/1**



**TOS SN50C TURNING**  
3 pieces



**SXKH MOULD FLIPPER**

Our technology investments continue to serve you faster with the best quality.





# Mould Design

We are aware of 'what' is really needed by customer and we design our moulds upon customer desires. While we are realizing our moulds as the finest, we are using our high field experience.

We know that each project has its own strict deadline. So, we are using our experience and high analyse capability and leading our investments in most innovative way to serve our customers better.

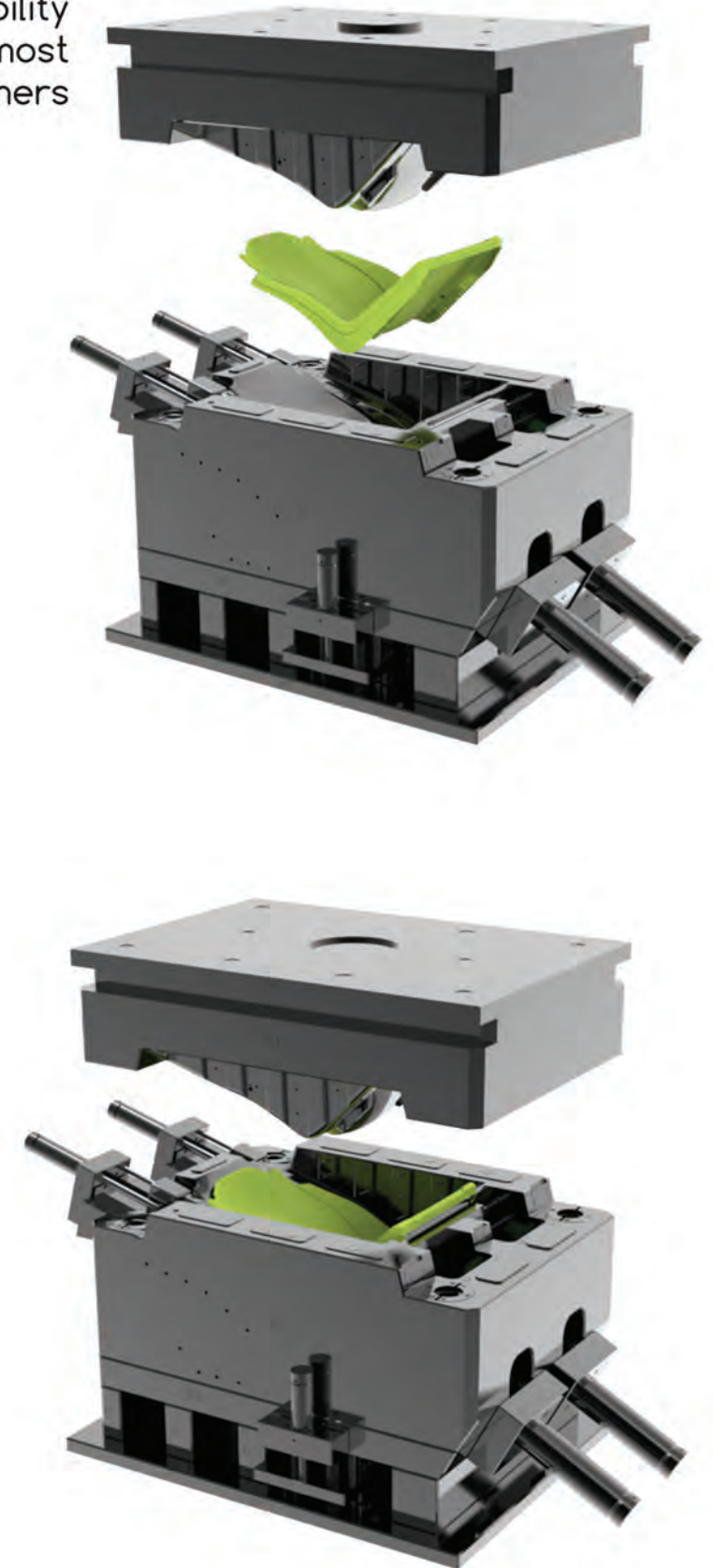
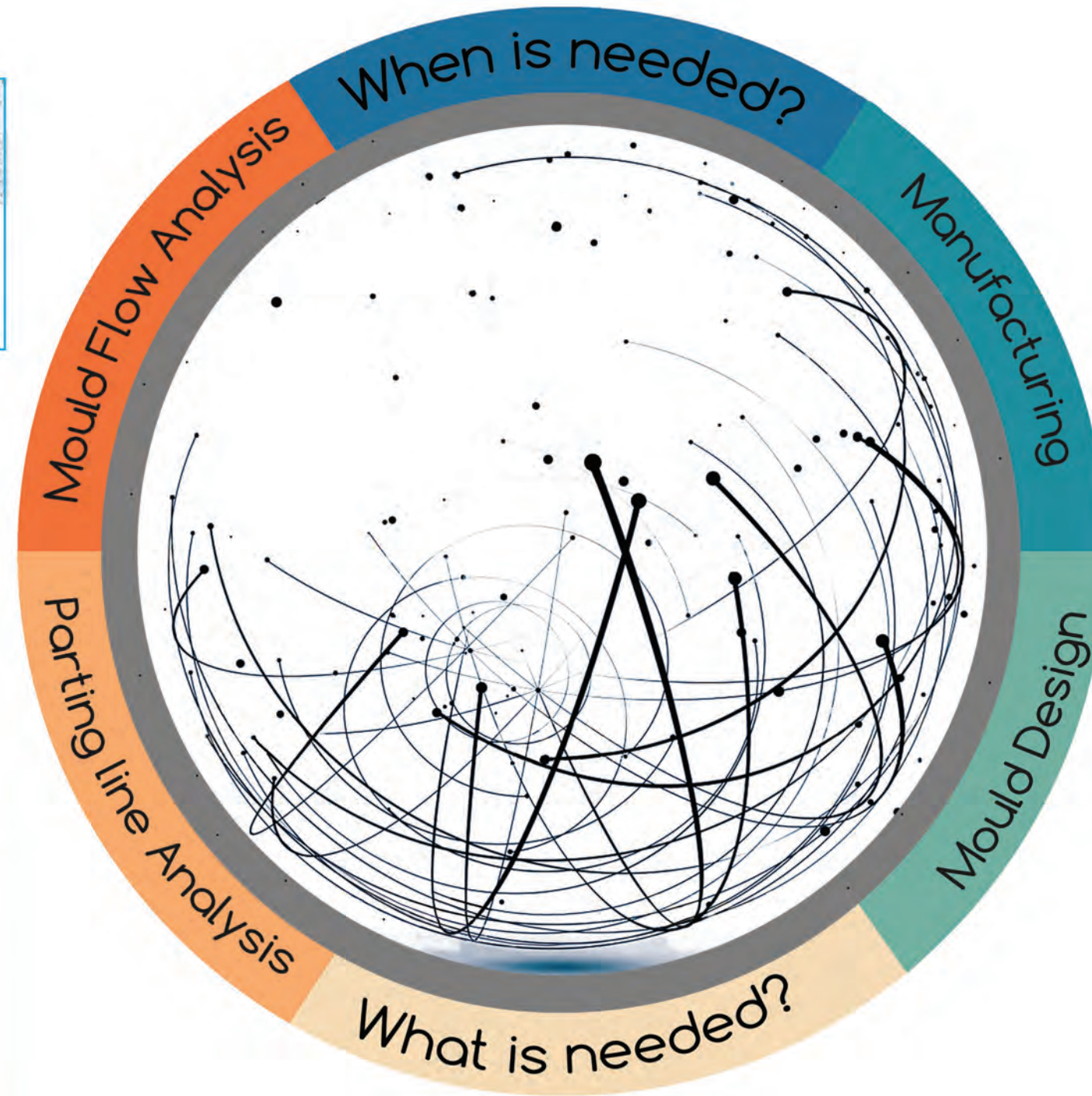





# Mould Factory

- > 4000 m<sup>2</sup> area
- > 40 CNC machines  
and more than half of them is 5 axis
- > Up to 2000 mm 5 axis machining capability
- > Experienced mould designers

## With these capabilities,

- > more than 3000 moulds completed
- > more than 200 moulds per year  
which are approximately 15 tons weight
- > each day 1 mould can be launched.

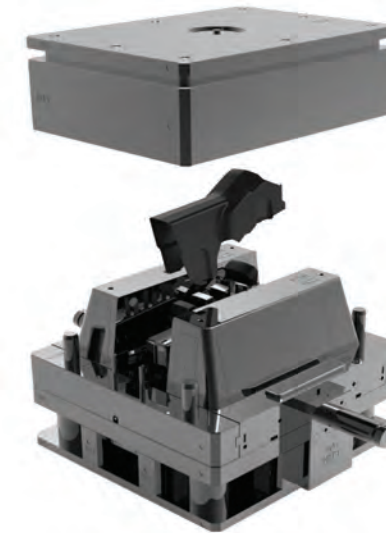
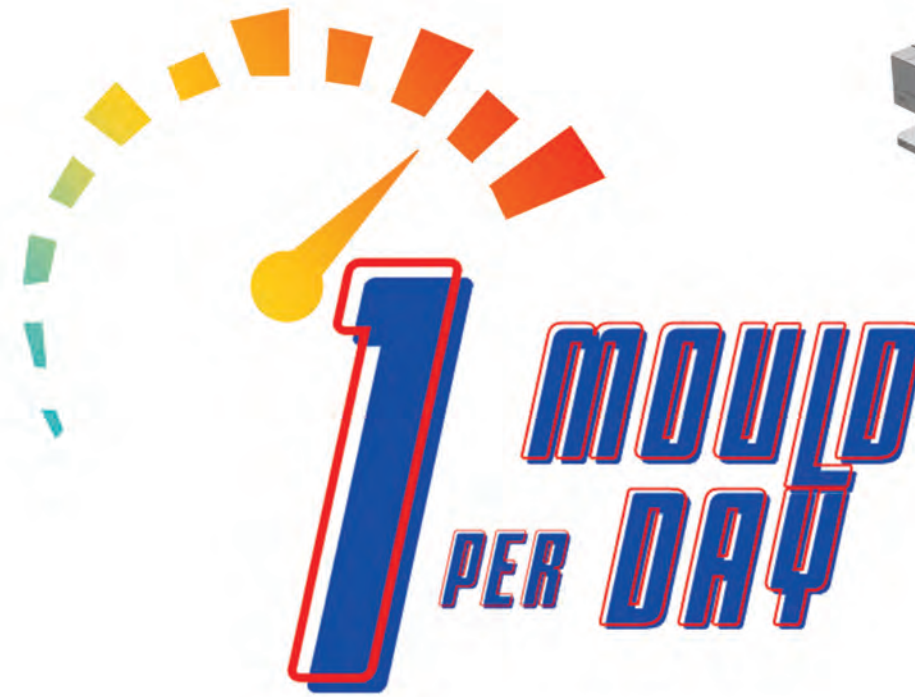

## Etko-Mould offers:

- > High quality
- > Competitive prices
- > Best deadlines for projects

## Etko-Mould's expertise include:

- > Plastic injection moulding
- > Aluminum injection moulding
- > Sheet moulding

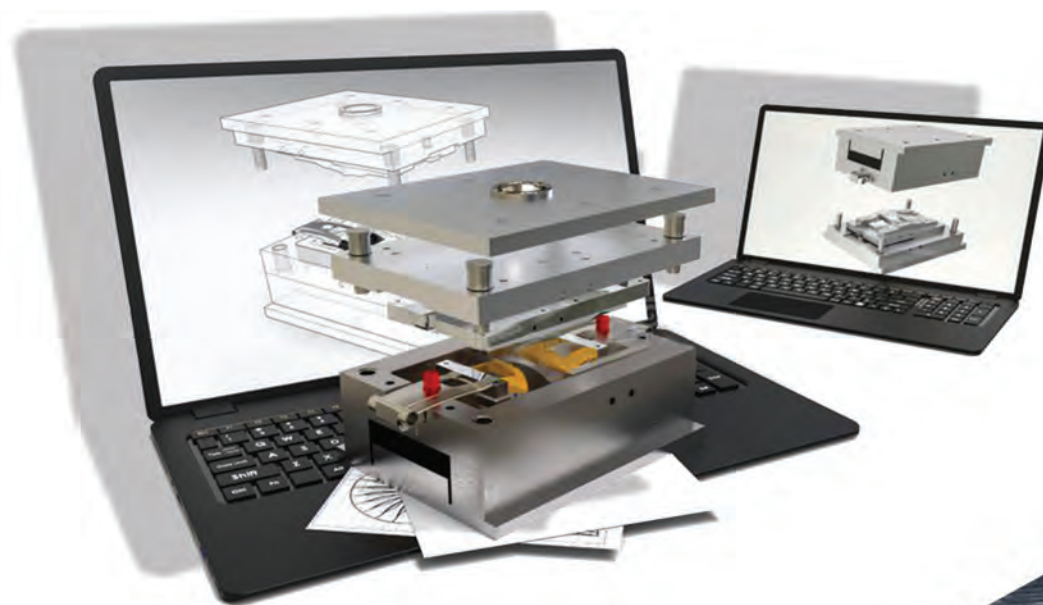





# Plastic Injection Factory

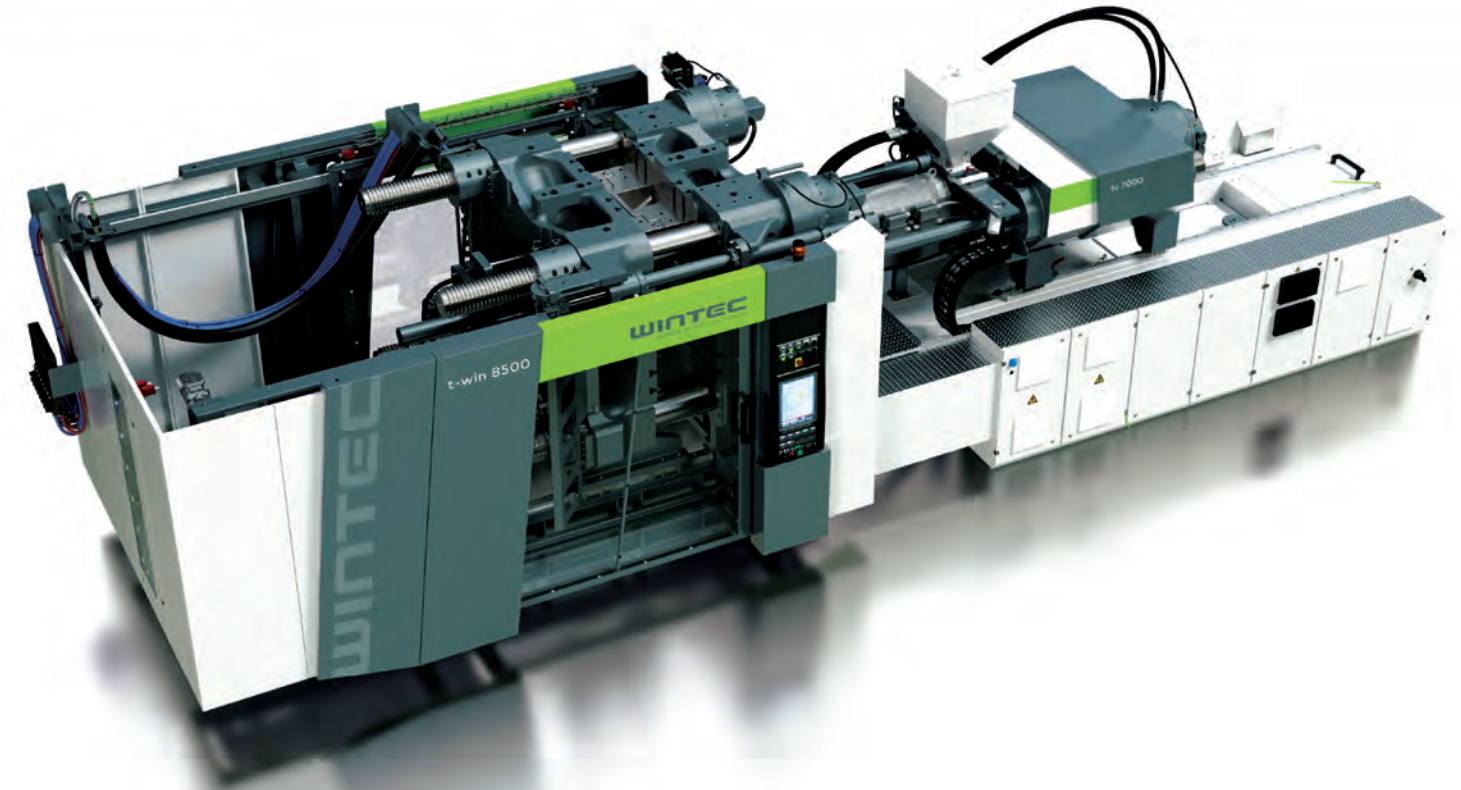

*P*roper  
*lan*

*P*recise  
*roduction*

With our 55 injection machines, we are able to produce 5000 tonnes plastic part per year. Wide range of raw material can be produced with wide range of machines from 60 tonnes to 3000 tonnes

- > 5000 tonnes plastic production capability per year
- > Machine Range 60 to 3000 tonnes
- > 55 Plastic Injection machines
- > Up to 25 kg plastic part capability
- > Specializing in low to mid-volume production
- > Providing ECE R118, EN 45545 & FMSS 302 regulations,

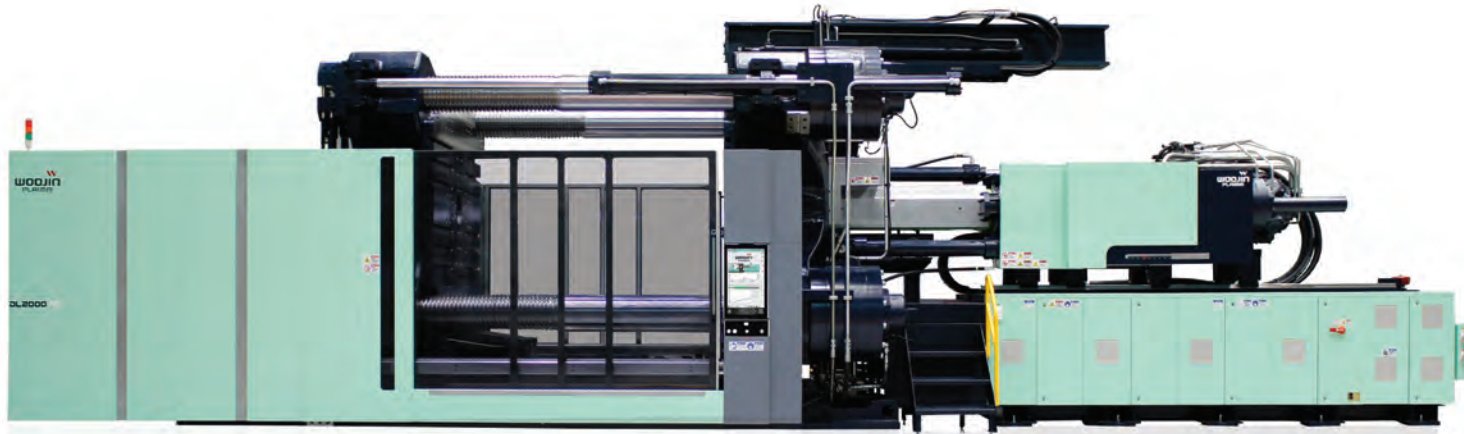

*Recycleable Raw Materials*





# Assembly Line



After producing the moulds of the parts and doing plastic injection production, all these production processes are supported with our assembly department.

In addition to our standart assembly capability, we have;

- ultrasonic welding,
- screen printing,
- hot stamping,
- sewing.

• Plastic Seats



• Armrests



• Snack Tables



• Interdoor Lights



• Footrest



• Exterior Trim Parts



• Interior Trim Parts

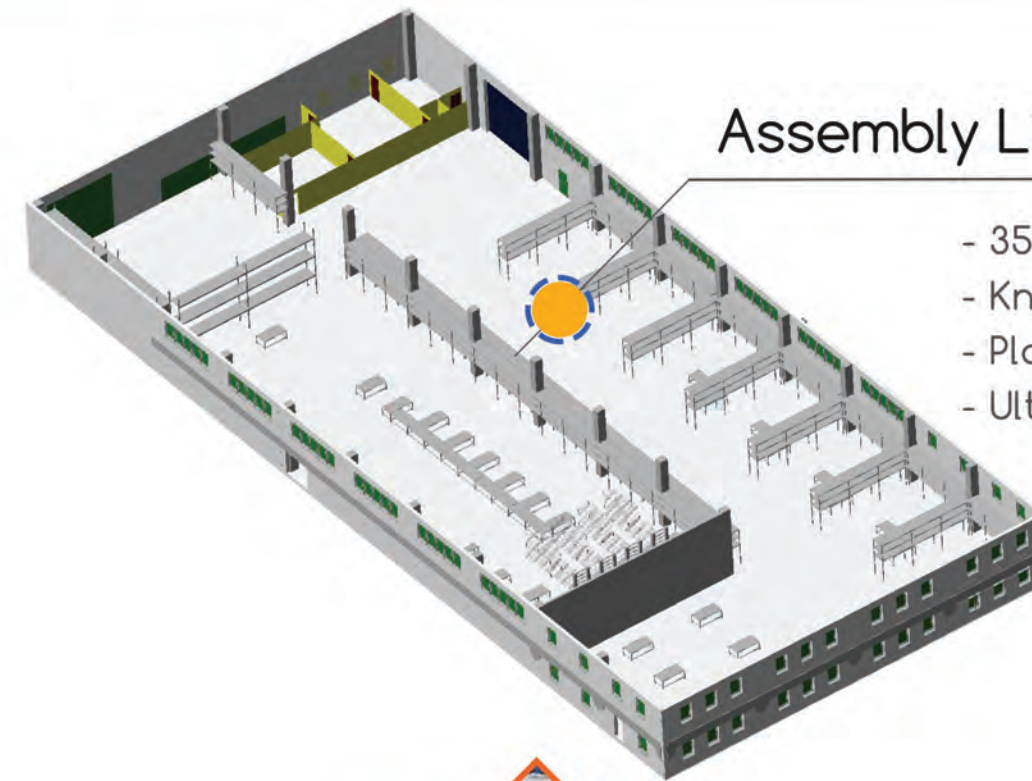

## Assembly Lines & Warehouse

- 3500 m2 area
- Knitting machines
- Plastic injections machines
- Ultrasonic weldings







## Knitting Department



At our Knitting Department, we are able to produce nets with our 8 bar two needle bed knitting machines.

This allow us to produce :

- Nets with elastical edges,
- Elastical nets,
- Different sizes with different patterns

In addition to this production capability, we also meet

- Automotive
- Railways
- Aircraft standarts on our nets.

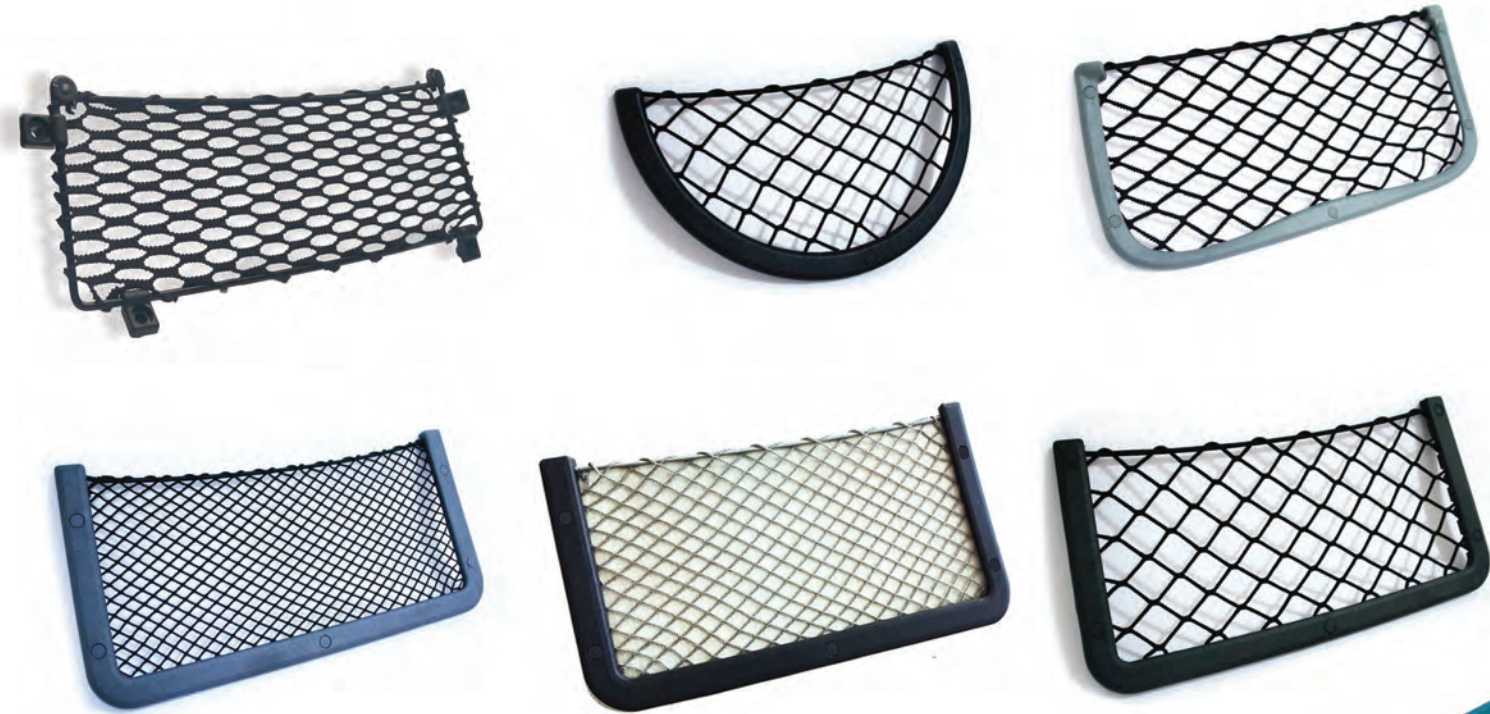





# Product Range

**PLASTIC SEATS**

etka-d  
mould & plastic

**SNACK TABLES**

etka-d  
mould & plastic

**ARMRESTS**

etka-d  
mould & plastic

**FOOTRESTS**

etka-d  
mould & plastic

**HANDLES**

etka-d  
mould & plastic

**MAGAZINE NETS**

etka-d  
mould & plastic

**HAND RAIL HOLDERS**

etka-d  
mould & plastic

**BACKREST COVERS**

etka-d  
mould & plastic

**INTERDOOR LIGHTS**

etka-d  
mould & plastic

**OTHER ACCESSORIES**

etka-d  
mould & plastic

**INTERIOR TRIM PARTS**

etka-d  
mould & plastic

**EXTERIOR TRIM PARTS**

etka-d  
mould & plastic





# Certificates



# Global Service



We are not selling to Antarctica yet.

## Some of our references

CERTIFICATES



ISO 9001:2015

